

• FURNITURE • LAMINATES • BAMBOO

# Indian Wood & Allied Panels

Volume 17 • Issue 4

*A Quarterly Publication on Plywood / Wood & Bamboo Based Panel Products*

October - December 2023



**Wood certification to give information  
on source of forest products**

.....page 8



**Rule change on logs could  
kickstart India trade.....page 17**



**SPAN FLOORS** Introduces Vulcan TG 9,  
Wood Soffit Panelling.....page 23

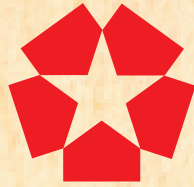

# CENTURYPLY®



**CENTURYPLY®**



**CENTURLAMINATES®**



**CENTURYVENEERS®**



**CENTURYDOORS®**



**CENTURYEXTERIA®**  
Decorative Exterior Laminates



**CENTURYPROWUD®**  
*MDF-The wood of the future*



**CENTURYSPB®**  
SOLID POLYMER BOARDS



**CENTURYWPC®**  
WOOD POLYMER COMPOSITE



**CENTURY PARTICLEBOARD®**  
The Eco-friendly and Economical Board

**SAINIK 710**

WATERPROOF PLY

**SAINIK LAMINATES™**

BOLD & BEAUTIFUL

**CENTURY PLYBOARDS (INDIA) LTD.**

Century House, P-15/1, Taratala Road, Kolkata - 700 088

For any queries, SMS 'CPIL' to **56070**

or call us on **1800 5722 122**

### Editorial Advisory Board

Mr. A.K. Mukherjee  
Dr. J. Bhattacharyya  
Dr. C.N. Pandey  
Mr. Sajjan Bhajanka  
Mr. P.G. Mukundan  
Mr. Ajoy Kumar

### Editor

Jaydeep Chitlangia

### Hony. Country Editors/Representatives

Mr. Olman Serrano, FAO - Rome

### Indian Correspondents

Dr. A. Panda

### Advertising/Business Development

Anthony Fernandes

### Graphic Design & Layout

Sushil Kumar

### Editorial & Publisher's Office

#### Federation of Indian Plywood & Panel Industry (FIPPI)

404, Vikrant Tower, 4 Rajendra Place,  
New Delhi-110 008, India  
Tel: +91-11-25755649,  
Fax: +91-11-25768639  
E-mail: fippi@fippi.org,  
Website: www.fippi.org

The views expressed in this issue are not the views of the Publisher or Editor.

*No part of this magazine may be reproduced in part or in full without the permission of FIPPI.*

### SUBSCRIPTION

“Indian Wood & Allied Panels” is published four times a year.

### Mode of Payment:

Demand Draft /Cheque to be issued in favour of “Federation of Indian Plywood & Panel Industry”, payable at New Delhi.

Subscription Charges	India INR	Overseas US\$
One Year	800	80
Five Year	4000	400

Printed & Published by Anthony Fernandes, on behalf of Federation of Indian Plywood & Panel Industry.

# C O N T E N T S

2

Market trends



12

Built Environment Innovation Hub unveiled in Singapore to showcase and accelerate built environment technologies



18

Century Plyboards target revenue of ₹12000 crore by 2031

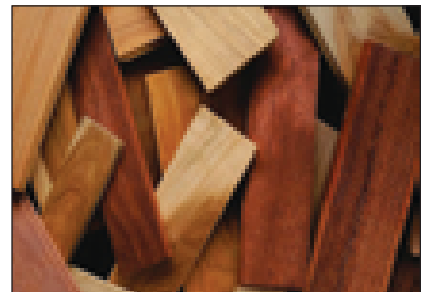

19

India trade council joins forces with global body to boost furniture manufacturing

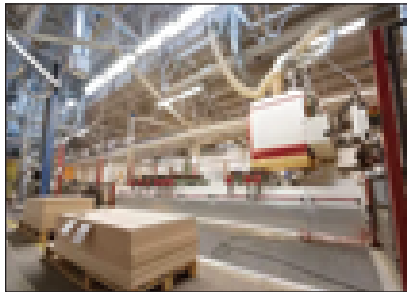

Wood certification to give information on source of forest products	8
Dr. C.N. Pandey Felicitated by Indian Academy of Wood Science	9
Greenply MDF Unveils EPA Certified CARB P2 & BOIL PRO 500	
A Delightful Amalgamation of Marble and Oakwood Scalloped With Handmade Tiles in this....	10
Agroforestry is a key climate solution, Director-General says at FAO Council side-event	11
Constitution of the Indian Forest and Wood Certification Council	13
CenturyPly unveils India's largest integrated wood panel manufacturing plant in Andhra Pradesh	14
IIFM organises one-week training course of IFS officers	
Duroply launches decorative veneer named 'Bohemia'	15
India was a 'hot' topic of discussion at the 125th National Hardwood Lumber Association....	
Amulya Mica organized a Dealers Meet at Gauhati Assam on 11th December 2023	16
Rule change on logs could kickstart India trade	17
After a decade, Cochin Port receives timber log shipments from Brazil	18
Amulya Mica participated in Dine with Designers (City Talk, Hisar) event on 2 December 2023	20
BIS Announces Revised Concession Fees for MSMEs and Women Entrepreneurs	21
NeXTimber produces first CLT panel, begins taking orders	
Mato Grosso aims to expand wood exports to larger global markets	22
Japan witnesses a great rise in mass timber	
Samling Timber Malaysia Signs MOU with Australia-Based Loggo IP to Develop Engineered....	23
SPAN FLOORS Introduces Vulcan TG 9, Wood Soffit Panelling	
India, New Zealand discuss measures to cut trade barriers, promote investor-friendly environment	24
Bamboo trees planted to help raise water table:Delhi LG VK Saxena	
'Will boost India's mission for clean, green growth': PM Modi lauds Assam govt's mega....	25
Request for Extension of QCO for Wooden Based Boards	
India Aims For Global Leadership In Quality Products, 'Zero Defect, Zero Effect' Takes Center...	26
Greenpanel India's Innovative outdoor marketing campaign in Ayodhya	
2024 Events Calendar	28

## Market trends

*A forecast future shortage of timber, especially wood for construction, could have its greatest impact in developing economies*

*By Mike Adams*



*Supplies in demand: Sawnwood at a depot in Malaysia. Photo: S. Lori.*

**F**orecasts of demand for timber point to a significant imbalance in future wood supply and demand by mid-century. Driven by rising living standards and urbanization, demand for timber is expected to grow dramatically in the next decades. But long growing times and constraints on the expansion of plantations mean that supply will struggle to keep up.

The World Bank was among the first to point to a looming wood shortage. In a 2016 report,<sup>1</sup> the Bank noted that global demand for timber products was growing rapidly and predicted that demand for industrial roundwood (IRW) would quadruple by 2050. Such an increase would far surpass supply growth in the same period, raising the risk of unsustainable harvesting.

Since then, several other analyses have reinforced the impression that markets will tighten significantly in future. This article summarizes key findings from three credible sources and draws some ominous conclusions, especially for countries making progress toward their development goals.

### The outlook for tropical timber

In 2021, ITTO published an analysis of tropical timber supply and trade through 2050.<sup>2</sup> Its forecasts were developed

using a model with the goal of identifying future supply gaps and opportunities to invest in sustainable forestry.

According to the ITTO study, overall roundwood timber production in tropical regions will decline through 2050 due to decreasing woodfuel consumption, though total woodfuel production will remain higher than IRW production.

Still, across the three tropical timber producing regions of sub-Saharan Africa, Latin America and Southeast Asia, IRW production will grow by nearly one-quarter between 2015 and 2050. These three regions will be net exporters of IRW in 2050, accounting for 19% of global production.

Plantation forestry will be the main source of IRW in tropical producer regions in 2050. IRW production in natural forests will remain fairly stable.

<sup>1</sup>World Bank. 2016. *World Bank Group Forest Action Plan FY16–20*. World Bank, Washington DC. Available at: <https://documents1.worldbank.org/curated/en/240231467291388831/pdf/106467-REVISED-v1-PUBLIC.pdf>

<sup>2</sup>Held, C., Meier-Landsberg, E. & Alonso, V. 2021. *Tropical timber 2050: an analysis of the future supply of and demand for tropical timber and its contributions to a sustainable economy*. ITTO Technical Series No. 49. International Tropical Timber Organization (ITTO), Yokohama, Japan. Available at: [www.itto.int/technical\\_report/](http://www.itto.int/technical_report/)



**RUSHIL**  
DECOR LIMITED  
WE'LL MAKE IT



# BLUEPRINTS OF OUR GREEN FOOTPRINTS

Our manufacturing unit in Visakhapatnam has been awarded the IGBC Green Building certification.



#### Certification Milestone

MDF Board unit in Visakhapatnam to receive Green Building Certification

#### Green Landscaping

32% plant site covered with vegetation  
50% are drought-tolerant species

#### Cost Savings

64.58% of energy cost savings

#### Energy Efficiency

40% reduction in energy consumption  
30% reduction in water consumption

#### Government Support

50% reimbursement for green measures

#### Wastewater Excellence

100% wastewater treatment at plant.



We at Rushil Décor dedicate this accolade to our customers and the future generation.

Toll Free No.: 1800 233 7952  
www.vir-mdf.com | info@rushil.com

**Other key forecasts from the ITTO report include:**

- Total global production of roundwood will increase by 13% by 2050, to 4.3 billion m<sup>3</sup>. Total production volume of roundwood in tropical timber producer regions in 2050 is projected at 1.3 billion m<sup>3</sup>, of which woodfuel will account for 57%.
- Global woodfuel production will decrease from 1.8 billion m<sup>3</sup> in 2015 to 1.5 billion m<sup>3</sup> in 2050, a decline of 21%. The decrease will mainly be due to reduced consumption in sub-Saharan Africa.
- Global IRW production is projected to grow by 45% by 2050, to 2.8 billion m<sup>3</sup>, but tropical production will increase by only 24%, to 533 million m<sup>3</sup>.
- Plantations produced an estimated 67% of IRW supply in the tropical regions in 2015 and this proportion is projected to increase to 73% by 2050. The biggest increases in forest plantation area are expected in Southeast Asia and Latin America.
- With limited expansion possibilities for large-scale plantations, smallholders and agroforestry systems will become important producers. Both need further improvements in productivity and timber quality.
- Private equity capitalization and incentives for small-to-large plantation-based enterprises will be crucial for stimulating sector growth.

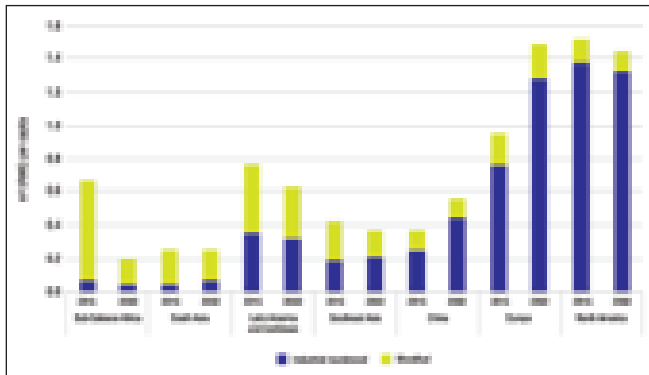

Source: Tropical Timber 2050 (Held et al. 2021).

**Figure 1: Per-capita consumption of industrial roundwood and woodfuel in 2015 and 2050, by selected world region.**

**Plantations needed**

In 2022, the Food and Agriculture Organization of the United Nations (FAO) published an analysis of the global forestry sector also featuring an outlook through 2050.<sup>3</sup>

FAO projects that consumption of primary processed wood products will increase by 37% between 2020 and 2050 to 3.1 billion m<sup>3</sup> roundwood equivalents (RWE) (Table 1). Demand for wood products to substitute non-renewable materials (mass timber and man-made cellulose fibre) may increase by up to 272 million m<sup>3</sup>.

<sup>3</sup>FAO. 2022. Global forest sector outlook 2050: Assessing future demand and sources of timber for a sustainable economy – Background paper for The State of the World’s Forests 2022. FAO Forestry Working Paper, No. 31. Rome. Available at: [www.fao.org/3/cc2265en/cc2265en.pdf](http://www.fao.org/3/cc2265en/cc2265en.pdf)

Depending on the use intensity of wood industry residues, the resulting IRW demand may grow by 0.5–0.9 billion m<sup>3</sup> by 2050 compared to 2020. In addition, up to 199 million m<sup>3</sup> would be required to substitute for non-renewable materials.

Scenarios for future woodfuel consumption are wide-ranging. Most indicate global consumption of wood from forests in energy uses of 2.1–2.7 billion m<sup>3</sup> in 2050, compared to 1.9 billion m<sup>3</sup> in 2020.

The report concludes that at least 33 million ha of additional highly productive plantation forests would need to be established to meet the basic increase of demand for IRW through 2050, if naturally regenerated forest production remains stable. This estimate is roughly in line with other studies that estimate plantation area growth of between 20 million and 40 million ha by 2050.

The FAO study estimates the investments required to maintain and expand IRW production at about USD 40 billion per annum by 2050.

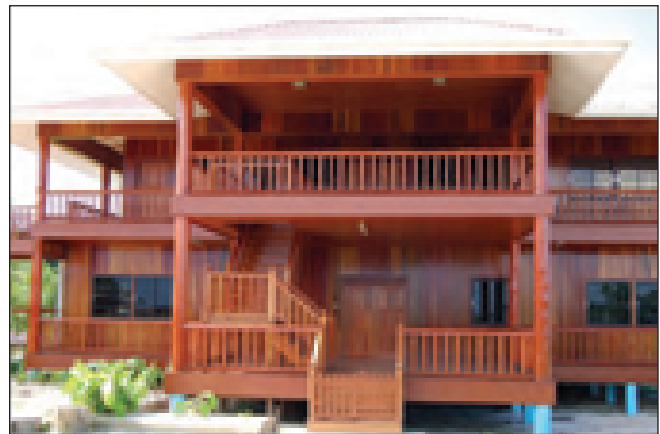

Growing demand: House construction is set to drive up global demand for timber. Photo: P. Bholanath

Meeting future demand for woodfuel will require optimized resource allocation and a clear political vision of the contribution of wood energy to the renewable energy mix in 2050. Woodfuel will remain the main energy source for many households in emerging economies.

**Table 1: 2050 outlook for key primary processed wood products.**

	2020 million m <sup>3</sup>	2050 million m <sup>3</sup>	% change
Softwood	929	1205	30
Veneer and plywood	267	539	102
Particle and fibre board	345	593	72
Wood pulp	745	786	6
<b>Total</b>	<b>2286</b>	<b>3123</b>	<b>37</b>

Source: Global Forest Sector Outlook 2050 (FAO 2022).

The FAO study suggests increasing demand for some wood products as substitutes for non-renewable materials, mainly in the construction sector and to substitute for mineral oil-based polymers (such as plastics and polyester fibre). The forest sector has developed and introduced suitable products for



# E-0 Plywood

CARB Certified

## Jo De

### Saari Zindagi Apka Saath

# AMULYA KA MISSION ZERO EMISSION



Eco-Safe:  
Zero residual  
formaldehyde  
plywood



CARB Certified:  
International  
quality assured  
plywood



Fire-Retardant



Pure Air:  
Safeguard indoor  
air quality



Allergy-Free:  
No skin rashes  
or eye irritations



Industry Leader:  
Among the top  
4 in 4000

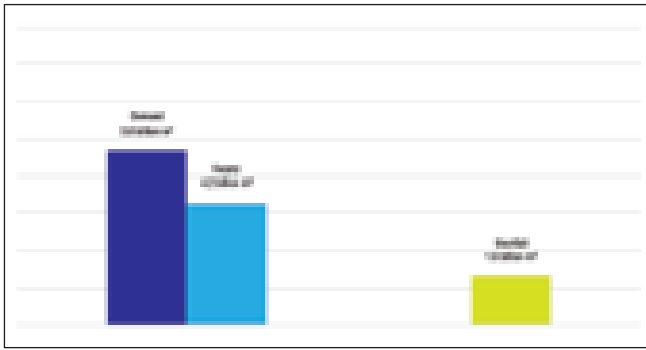

Source: Global timber Outlook (Gresham House 2020)

**Figure 2: Forecast global supply and demand for timber in 2050**

these markets, though production capacities are still small and production prices are often not yet competitive.

The most promising wood products for large-scale substitution are mass timber and engineered wood products for use in construction. The FAO study focuses on these products to illustrate the potential impact of enhanced demand for wood in a sustainable economic context.

**Low-carbon construction**

Another study of the outlook for the global timber industry was published in 2020 by Gresham House, a London-based financial asset management company.<sup>4</sup>

The Gresham House analysts noted that over the previous 20 years global timber consumption had increased by 1.1% per annum. In the 30 years through 2050, that growth is expected to accelerate to 3.1% per annum, driven by urbanization, decarbonization and increased housebuilding.

The global urban population is forecast to rise 53% between 2020 and 2050 and prosperity will increase for most people. Both urbanization and rising gross domestic product per capita increase demand for wood. In China, for example, which has experienced a 96% increase in the number of urban residents in 20 years, consumption of IRW also rose by 96%, the report noted.

Regarding decarbonization, the report points out that the vast majority of countries have set targets to reduce carbon emissions towards net zero by 2050, and that timber will play a critical part in this transformation. In addition, demand for biomass as a renewable energy source is also rising fast.

“The dual effect of urbanization and decarbonization will be more new homes and cleaner low carbon intensity buildings being built from timber,” the report said. “Wood will increasingly replace high carbon intensive steel and concrete.”

As a result, Gresham House forecasts an almost three-fold increase in timber consumption over the next 30 years, from 2.2 billion m3 in 2020 to 5.8 billion m3 in 2050 (Figure 2).

But this rise in demand is set against a constrained supply fixed by the growth rate of trees and the limited land area available for afforestation. The report cited forecasts for long-term, sustainable timber supply through 2050 of 3.7–4.7 billion

<sup>4</sup>Global Timber Outlook. Available at <https://greshamhouse.com/wp-content/uploads/2020/07/GHGTO2020FINAL.pdf>

m3 and predicted that the shortfall (of some 1.6 billion m3) imbalance will result in higher timber prices.

**An unfillable gap?**

Most of the global commercial timber supply is sourced from temperate forests in the northern hemisphere (Canada, the United States of America, northern Europe and the Russian Federation) and plantations in Oceania (New Zealand and Australia), where climates permit the growing of softwood timber.

Afforestation rates have been low and future afforestation and restocking of commercial plantations will not be able to meet increasing demand. Even if softwood afforestation levels were to increase rapidly, supply would not be impacted for at least 30 years. Further, most of the current standing stock not yet harvested is in remote areas such as north eastern Russian Federation and northern Canada, where it will be harder and more expensive to harvest.



*An unfillable gap? The growing prosperity of consumers and investments in housing will drive up timber demand for construction. Photo: Universidad de Guadalajara.*

Meanwhile, the increase in urban dwellers is concentrated in regions with insufficient resources of mature construction timbers. The growing prosperity of consumers in Asia and Africa and their investment in housing will drive up timber demand for construction.

Natural tropical forests contain a wide diversity of species which exhibit widely different strength and durability characteristics which would present a challenge in producing mass timber products such as laminated veneer lumber (LVL) or cross-laminated timber (CLT), for example, which are more suited for production from uniform plantation wood. Given this difficult outlook, alarm bells should be ringing in tropical countries experiencing strong economic growth and rapid urbanization and plans need to be prepared to deal with a coming supply gap in traditional timber construction products. □

**Indian Wood & Allied Panels**  
*A Quarterly Publication on Plywood / Wood & Bamboo Based Panel Products*

**READ!**

**SUBSCRIBE!**

**ADVERTISE!**

**For more details:**  
 Tel.: +91-9891788269, +91-11-25755649, E-mail: [fippi@fippi.org](mailto:fippi@fippi.org)

# REVOLUTION IN DOOR INDUSTRY

# TESA HDHMR DOOR

## AVAILABLE IN

### LENGTH (FEET)

6.5, 6.75, 7 & 8

### WIDTH (INCH)

27, 30, 33, 36, 39,  
42 & 45

### THICKNESS

30MM, 32MM & 35MM



PERSIAN WALNUT - 3371

- Ready To Use Doors
- Best Finishing, Unique and Rich Look
- Solid Structure, No Core Gap
- Smooth Surface, Zero Bubble Finish
- All Season Product & Dimensionally Stable
- Cost Effective
- Easy Locking System

 <b>HIGHER DENSITY</b>	 <b>TOUGHER THAN PLYWOOD</b>	 <b>NOMINAL COST</b>	 <b>HIGHLY WATER RESISTANCE</b>	 <b>BORER RESISTANCE</b>	 <b>MULTIDIMENSIONAL BONDING TECHNOLOGY</b>	 <b>HIGHER SCREW HOLDING STRENGTH IN CORE</b>	 <b>ZERO BUBBLE FINISH</b>	 <b>IDEAL ROUTABLE SUBSTRATE</b>
--	--	--	---	--	---	---	--	--



**BALAJI ACTION BUILDWELL:**

**Customer Care Service:** 011-41120018, 41120098

cce2@actiontesa.com, cce3@actiontesa.com

**PRODUCT RANGE :** •Pre-Laminated & Plain Particle Board, MDF & HDHMR Board  
•HDHMR Door •HDF Laminated Flooring •Embossed HDF Board •UV Coated Board  
•High Gloss Acrylic Board •Door Skins



## Wood certification to give information on source of forest products



**T**he Indian government has launched the Indian Forest & Wood Certification Scheme to promote sustainable forest management and agroforestry practices. The scheme provides an environmental label, called PRAMAAN, to inform consumers about the origin and source of forest and tree-based product. It offers certification for individual farmers, groups of farmers, institutions, and industries involved in agroforestry and wood-based industries. The certification process will be conducted by independent bodies accredited by the National Accreditation Board for Certification Bodies.

In order to encourage sustainable forest management and agroforestry practices in the country, the environment ministry has recently launched the Indian Forest & Wood Certification Scheme that will provide an environmental label informing both domestic and international consumers about the origin and source of the forest and tree-based products.

Since the scheme will allay concerns of such green-conscious consumers over deforestation and illicit timber trade through certification, it will increase the export potential of India's wood-based products.

"Certified products would be sold on competitive domestic and global markets and thus encourage consumers towards green products," said environment secretary, Leena Nandan.

She said, "Certification under the scheme is available to individual farmers, groups of farmers, institutions, or industries engaged in agroforestry, wood-based industries, or any entities involved in the wood value chain.

The scheme offers a certification logo, bearing the brand

name PRAMAAN, which can be applied and used on the certified wood products or processed items. It includes forest management certification, tree outside forest management certification and chain of custody certification, right from origin to market, for both timber and non-timber forest produce.

Implementation of the scheme will be carried out by the Indian Institute of Forest Management, Bhopal, providing operational support and facilitating certification processes and procedures.

"The certification process will be conducted by impartial, competent, and independent certification bodies. These bodies will handle applications, conduct independent audits based on criteria and indicators outlined in the certification standards adopted by the Indian Forest and Wood Certification Scheme," said the Secretary.

The National Accreditation Board for Certification Bodies under the Quality Council of India will accredit the certification bodies which will carry out independent audits and assess adherence on the Indian Forest Management Standard, consisting of eight sustainability criteria, 69 indicators and 254 verifiers, which is an integral part of the National Working Plan Code 2023.

The Code was released last year for scientific management of forests and evolving new approaches. It deals in detail the essentials of forest management planning, incorporating the principles of sustainable management of forests. This includes extent and condition of forest and tree cover; maintenance, conservation and enhancement of biodiversity including

wildlife, forest health and vitality, conservation and management of soil and water resources, enhancement of forest resource productivity, maintenance and enhancement of social, economic, cultural and spiritual benefits.

It also provides for the appropriate policy, legal and institutional framework. For the first time, the National Working Plan Code 2023 has prescribed state forest departments to engage in continuous data collection and its updation in a centralized database.

The Indian Forest Management Standard which is a part of this code takes into account the diverse forest ecosystem in the country, while trying to bring in uniformity in management. The Standards for Sustainable Forest Management have been codified in the Indian Forest Management Standard, based on long term experiences of scientific forest management in India and in sync with international criteria and indicators. □

## Dr. C.N. Pandey Felicited by Indian Academy of Wood Science



**D**r. C.N. Pandey was felicitated by Indian Academy of Wood Science on 07-11-2023 where he delivered A.C Sekhar Memorial future series 1. The function was held in Bangalore. □

## Greenply MDF Unveils EPA Certified CARB P2 & BOIL PRO 500

**T**he latest milestone for Greenply Industries, one of India's largest interior infrastructure companies has been the obtainment of certification by the California Air Resources Board (CARB) & Environmental Protection Agency (EPA) for its recently launched CARB P2 MDF. Greenply is first in the industry to be certified with CARB and EPA for its Zero Emission plywood product range and now with the CARB certification for Greenply CARB P2 MDF, it is increasing its portfolio of zero-emission products, to fulfill the promise of healthy interiors. The CARB certification for Greenply MDF CARB P2 underscores the company's commitment to healthy interiors and reflects Greenply's dedication to meeting global quality standards. Greenply has always been an industry leader in creating products that are safe for both consumers and the environment.

Greenply commissioned its MDF production line in April 2023 at Vadodara, Gujarat. The facility uses state-of-the-art PRODIQ NEO technology in collaboration with Siempelkamp Germany. Ever since its launch, the brand has been capturing the market with its thrust on quality and product innovation.

In line with its innovative streak, Greenply Industries is also set to unveil its new product offering - Greenply MDF BOIL PRO 500, a boil proof 500 HDF that brings the promise of boil-proof and fire-retardancy in MDF.

Greenply MDF Boil PRO 500 is manufactured using HYDROFIRE BLOCK TECH, ensuring waterproof and fire-proof performance. It can bear heavy loads, and is resistant to termites, borers, and fungus. Additionally, it is environmentally friendly and possesses antibacterial, antifungal, and antiviral properties, offering a safe and hygienic solution. With high dimensional stability and production powered by renewable energy sources, Greenply MDF Boil Pro 500 is the responsible choice for today's construction and interior design needs.

The Greenply MDF Boil PRO 500, a revolutionary new product from Greenply Industries, will soon hit the market. It has been developed for a wide range of uses and offers several advantages over competing products.

Sanidhya Mittal, Joint Managing Director of Greenply Industries, proudly expressed, "The CARB certification for Greenply MDF CARB P2 represents our quest for innovation and healthy interiors. Ever since the launch of Greenply MDF, we have been aggressively pushing for new innovative products. In the line, our new product Greenply MDF BOIL PRO 500, will substantially bolster our product portfolio, offering even more choices and possibilities for consumers seeking waterproof and fireproof MDF." This remarkable product finds its applications across a wide range of areas, including restroom toilet cubicles, thermal insulation, load-bearing areas like decking and warehouse shelves, container and truck floors, bus and bathroom partitions, fire-retardant applications, flooring, wall paneling, furniture, fixtures, modular kitchens, wardrobes, and moisture-prone areas. □

# A Delightful Amalgamation of Marble and Oakwood Scalloped With Handmade Tiles In This Contemporary Panchkula Cafe | Loop Design Studio



Shree Rathnam, designed by Ar. Suvrita Bhardwaj and Ar. Nikhil Pratap Singh led Loop Design Studio, seeks to bridge the gap between South Indian architecture's vibrancy and the minimal modernist interiors' elegance. An intricate blend of marble and oakwood scalloping with handmade tiles creates a wonderfully balanced look in this modern cafe. The architects provided SURFACES REPORTER (SR) with additional information regarding the project.



Its interior design is formulated from bands and layers of different shades and textures, creating a single unity.

The warm colour tones of the Southern part of the Indian peninsula, and its hues reminiscent of the different shades of natural landscape, create a contrast in harmony at the heart of this volume. Its materiality attempts to complement the scene.



The striking intensity and sculptural quality of Indian marble are powerful symbols of the rich hues and grandeur of South Indian architecture. The stone is a beautiful representation of nature's work, enhancing the beauty and splendour of the outlet.

Marble blending with the warmth of oakwood scalloping and handmade tiles brings balance to the avant-garde layout. Contemporary furniture and greenery reinforce the atmosphere, as do the geometric designs on the wooden ceiling, adding an element of eclecticism to the volume.

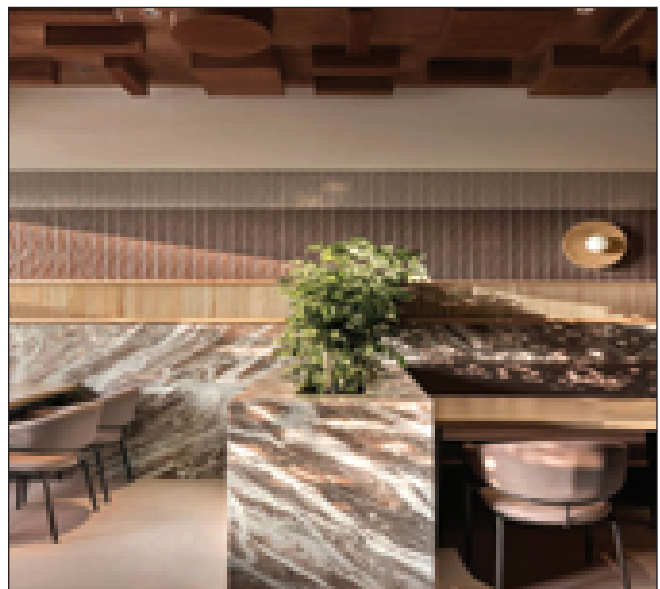

This space pays tribute to contemporary regional architecture with two distinct styles uniting together in harmony. □

# Agroforestry is a key climate solution, Director-General says at FAO Council side-event

*QU Dongyu calls for greater collaboration between forestry and agriculture sectors to scale-up agroforestry*



FAO Director-General addresses COFO-COAG Side Event during Council 174th session on “Scaling-up Agroforestry”

Agroforestry is a key climate solution with huge potential to simultaneously improve food security and nutrition and alleviate poverty, while halting deforestation, conserving biodiversity, building resilience, and helping to reduce greenhouse gas emissions, the Director-General of the Food and Agriculture Organization of the United Nations (FAO) QU Dongyu said.

He delivered his opening remarks at a special joint event of the FAO’s Committee on Forestry (COFO) and the Committee on Agriculture (COAG) on Agriculture-Forestry Linkages. The event entitled “Scaling up agroforestry” took place on the sidelines of the 174th Session of FAO Council (4-8 December 2023).

In his address, the Director-General highlighted the need for scaling up agroforestry and its numerous environmental and socio-economic benefits, noting that it will require concerted efforts to foster greater collaboration and knowledge-sharing between forestry and agriculture sectors.

According to the FAO’s State of the World’s Forests report in 2022, agroforestry can help restore over one billion hectares of degraded agricultural land, to increase soil fertility and agricultural productivity, while enriching ecosystem services and livelihoods.

The Director-General also emphasized agroforestry’s vital importance for millions of smallholder farmers whose

livelihoods depend on it. He also noted that it was paramount to create enabling environment to attract investors to help smallholder farmers apply innovative approaches.

“Farmers need access to training, technology, markets, and financial support to adopt agroforestry practices effectively,” the Director-General said.

To this end, Qu underscored the need for increased research and innovation which will improve our understanding of agroforestry systems and their benefits along the value chain and make it an attractive integrated business model for investment. The Director-General called on all relevant partners to work together to develop appropriate policies and practices. FAO is committed to support sustainable transitions to agroforestry in ways that meet the needs of smallholder farmers and transform agrifood systems for the better.

Other participants included Julie Emond, Chairperson of COAG (Canada); Guenter Walkner, Chairperson of COFO (Austria); and Michael Taylor, award-winning silvopastoral farmer (Australia).

The participants highlighted the potential of agroforestry as a cross-cutting solution to sustainably transform agrifood systems to be more efficient, inclusive, resilient and sustainable. The event showcased FAO’s work on agroforestry to Members, national experiences from Members and discussed ways forward for addressing the remaining barriers to agroforestry uptake. □

# Built Environment Innovation Hub unveiled in Singapore to showcase and accelerate built environment technologies



Guest-of-honour Minister Indraneel Rajah (middle) with BCA representatives (Image: BCA)

The Built Environment Innovation Hub (BEIH) was launched at Singapore's Building and Construction Authority (BCA) Braddell Campus on 26 Oct 2023.

Held at the new seven-storey Zero Energy Mid-rise Building (ZEB) and 16-storey Super Low Energy High-rise Building (SLEB), which were completed earlier this year, the launch was graced by guest-of-honour Indraneel Rajah, Singapore's Second Minister for Finance and Second Minister for National Development.

The BEIH aims to be a collaborative space to connect like-minded individuals and showcase innovative technologies of the built environment sector, and facilitate the transfer of ideas and knowledge to accelerate the transformation of the sector, be it in Singapore or globally.

In particular, the BEIH is in line with Singapore's Built Environment Industry Transformation Map (BE ITM), an initiative launched in 2022 to transform the entire building lifecycle with BCA's industry partners by harnessing emerging technologies and innovations to drive collaboration across various project parties.

These technologies and innovations will serve to cultivate a built environment that is "smart, productive and sustainable, poised to seize global opportunities".

Minister Rajah shared during the opening ceremony of the launch: "With the completion of [the ZEB and SLEB], which are

designed to support the built environment transformation, we are now re-positioning the campus as the BEIH.

"This is yet another step forward towards making our vision of an integrated and collaborative built environment ecosystem, with forward looking firms and innovative solution providers working together, a reality."

## Advanced manufacturing and assembling methods



Mass timber was used to construct the ZEB and SLEB of BCA Academy Braddell campus.

One of the key transformation areas of the BE ITM is to further the use of advanced construction methods, such as prefabrication and Design for Manufacturing and Assembly (DfMA).

The two new buildings of BEIH, the ZEB and SLEB, are successful case studies of advanced construction methods in Singapore. Both buildings are made using mass engineered timber.

According to BCA, constructing with mass timber has helped to shorten onsite construction time, minimise disruption to surroundings, and contributed to improved workmanship.

As mass timber is harvested from sustainably managed forests, mass timber buildings have lower carbon footprint and net carbon emissions compared to steel or concrete buildings.

Combined with other advanced construction methods, such as advanced precast concrete system (APCS) and prefabricated prefinished volumetric construction (PPVC), the construction of ZEB and SLEB achieved up to “15% productivity gain” in spite of COVID-19 disruptions, as well as “up to 80% reduction in onsite manpower”.

**Sustainability**



From right: Presentation by Dr Adrian Chong, National University of Singapore, assistant professor on the mixed mode ventilation system to Minister Rajah, and Heng Teck Thai, deputy CEO, BuildSG Office, BCA (Image: BCA)

Buildings account for over 20% of Singapore’s carbon emissions, and the cooling of buildings alone account for 40-50% of energy consumption in building operations, according to BCA. A challenge faced by office buildings is its heavy reliance on air-conditioning due to Singapore’s tropical climate, characterised by high temperatures and humidity all year round.

Growing demands for air-conditioning are also expected with increasing global temperature brought about by climate change. To reduce a building’s cooling energy consumption, BCA has collaborated with the National University of Singapore (NUS), Singapore Institute of Technology (SIT), Kajima Corporation, and Surbana Jurong Consultants to develop a mixed mode ventilation system which cools office spaces without relying on energy-intensive air-conditioning.

This was one of the novel technologies showcased at the BEIH launch. The proof-of-concept for the mixed mode ventilation system was conducted in BEIH over a two-week

period. A full-scale demonstration is set to commence in January 2024 in SLEB.

Furthermore, the use of mass timber offers high thermal resistance and thermal mass, which contributes to indoor temperature stabilisation.

Other sustainability technologies and strategies used in ZEB and SLEB include the strategic placement of non-air-conditioned ventilated common spaces on lower floors to achieve thermal comfort; the use of passive displacement ventilation, resulting in approximately 86% savings in fan energy consumption as compared to conventional systems; high-efficiency solar photovoltaic panels on ZEB’s roof; and more. As a result, both ZEB and SLEB are expected to achieve energy savings beyond 46%, exceeding the minimum 40% Green Mark 2015 baseline set by BCA.

Singapore’s Green Mark aims to provide a consistent method to assess and verify buildings for their overall environmental performance, assisting project teams to deliver a more sustainable built environment and encouraging best practices and market transformation.

**Knowledge skill and transfer**

The BEIH and BCA Academy also strive to support knowledge transfer in innovation and technology, through talent cultivation and competency development in its role as the Continuing Education and Training (CET) Centre for the built environment sector.

BCA will be prioritising in-demand and emerging skills in transformative areas to equip industry at all levels with knowledge and cutting-edge skills as the nation transits towards the refreshed ITM.

Additionally, as part of BCA Academy’s effort to increase the pool of mid-career entrants for forerunner firms, the academy will be launching a suite of five Skills Future Career Transition Programmes (SCTPs) for the built environment.

The SCTP is a initiative by Singapore to support mid-career individuals in acquiring industry-relevant skills to improve employability and pivot to new sectors or job roles.

One of the programmes includes sustainable design modules, such as ‘Sustainable Building Design Strategies’, ‘Advanced Digital Design for Sustainable Building’s, or ‘Green Building Design Criteria and Green Mark’. □

**Constitution of the  
Indian Forest and Wood  
Certification Council**

The Gazette notification No.3-19/2022-SU dated 12.12.2023 for the constitution of the Indian Forest and Wood Certification council has been notified by Ministry of Environment, Forest and Climate Change Government of India and President Federation of Indian Plywood & Panel Industry has been nominated as one of the Representative of woodbased industries as a member. □

## CenturyPly unveils India's largest integrated wood panel manufacturing plant in Andhra Pradesh

The plant was inaugurated by Andhra Pradesh Chief Minister YS Jagan Mohan Reddy in the presence of CenturyPly Chairman Sajjan Bhajanka and other senior officials.

Century Plyboards (India) Ltd. inaugurated India's largest integrated wood panel manufacturing plant at Badvel in Andhra Pradesh.

Spread across 100 acres, the plant will have a total investment of Rs 1,000 crore in the second phase and is expected to generate direct and indirect employment for 2,000 people over the next 5 years, the country's largest manufacturer of wood panels said in a statement.

The first phase saw an investment of Rs 950 crore. The plant was inaugurated by Andhra Pradesh Chief Minister YS Jagan Mohan Reddy in the presence of CenturyPly Chairman Sajjan Bhajanka and other senior officials.

"YSR Kadapa district holds an important place on the industrial map of Andhra Pradesh for its valuable repository of resources.

"As the government has earmarked this region as a potential agro-industry hub, this initiative of CenturyPly marks the beginning of a series of investments of other industrial entities that will follow, leading eventually to making it a significant hub of furniture for the entire country," Bhajanka said in the statement.

The plant comprises two large-size laminate presses, which are already operational. The MDF (Medium Density Fibre) and



PVC (Polyvinyl chloride) units are in the advanced stages of commissioning. We have invested Rs 700 crore in MDF and Rs 250 crore in laminates and PVC in the first phase.

The new unit will increase our production capacity in MDF by a 950-meter cube, which will double our footprint in this segment. The second phase will see an investment of Rs 1,000 crore in expansion plans," Bhajanka said.

The Andhra Pradesh government has also expressed its commitment to supporting the growth of the wood panel industry in the state. The Kolkata-based company also has 8,55,000 laminate sheets, 3,13,500 CBM in MDF and 15,000 tonne in PVC at the Andhra Pradesh site. □

## IIFM organises one-week training course of IFS officers

The Indian Institute of Forest Management, Bhopal commenced its Week-long training course on "Forest Certification and Commercial Agro-Forestry" for IFS officers from various states on December 11, 2023. The speakers for the first day of the training course were – A K Johari, Former PCCF, Assam, Dr. K. Ravichandran, Director, IIFM Bhopal and Dr. Manmohan Yadav, Professor & Course Director, IIFM.

A K Johari, who was also a member of National Working Plan Code revision committee highlighted the salient features of the National Working Plan Code 2023. He informed the participating officers that the NWPC 2023 has formerly adopted the principles of Sustainable Forest Management (SFM) which were developed by IIFM under the Bhopal-India process. He further emphasized that henceforth all working plans for the forest divisions in the country shall be mandatorily prepared using this new code before the approval of the Govt. of India.

Dr. K Ravichandran in his address informed that the Indian Forest Management Standard developed by IIFM has been incorporated in the new working plan code. The working plan will be reviewed mid-term, after 5 years of commencement using

these standards. Dr Ravichandran further informed that moving ahead India has come out with its own certification scheme namely Indian Forest and Wood Certification Scheme (IFWCS). This scheme will be applicable not only to all the government owned forest lands but also for the commercial plantation raised on farmers lands. This scheme matches with any international forest certification scheme and this would help certified products to gain access to domestic and international markets. He further informed that the IIFM has been designated as the scheme operating agency for the implementation of IFWCS.

Dr. Manmohan Yadav discussed in detail the evolution of the concept of Sustainable Forest Management and Forest Certification. Dr Yadav highlighted key features of the global forest certification schemes – Forest Stewardship Council (FSC) and the Programme for Endorsement of Forest Certification schemes (PEFC) and the Indian Forest and Wood Certification Scheme. Dr. Yadav highlighted that the European Union and other regions are bringing stringent regulations for imports of wood / timber products in their countries. □

## Duroply launches decorative veneer named ‘Bohemia’



**D**uroply, India’s premium and most experienced plywood manufacturer amongst the leading players has launched one of its kind decorative textured veneer under the brand name ‘Bohemia’. Addressing the needs of those who live life on their own terms, the product has been conceptualized after intensive consultations with architects and interior designers.

Explaining about the product true to its name, Akhilesh Chitlangia, Executive Director and Chief Operating Officer, Duroply, said, “At Duroply, we have customers at the centre of our new Product Development process. Our market research suggested the need of a premium and aesthetic textured decorative veneer for the avant-garde audience. In consultation with the leading architects and interior designers, we finetuned attributes of the product and are offering it in five textures. To appeal the sensibilities of bohemian audience, we have offered the product in Italian colors. Further, our team added the benefits of durability and lifetime guarantee to make it the most attractive offering in the industry. We have had very enthusiastic initial response to Bohemia.”

Bohemia can be used where consumers have a direct physical contact with the furniture surface like backrest of the bed, cupboards, and doors etc. So, it can be used in Office Spaces, Home Interiors, Furniture, Doors, Partitions etc. One can add polish to Bohemia and give it a matt or open grain feel. Textured veneer look of surface enhances elegance of wood and gives an affluent and classy feel to the proud owner. Textured feel of the surface makes one feel the surface, time and again and revel in its splendour.

Available in size 8 feet x 4 feet, Bohemia is 4 MM thick. Back face of 0.55 mm provides strength to Bohemia lengthening

its durability. Bohemia can be used wherever wood veneer are used making it multi-purpose.

Bohemia is available in five textures: Flute, Channel, Ribbed, Linen and Tube; thus, making this product available for a variety of uses. Product is available in Italian colours appealing to the fine sensibilities of those who live life on their own terms. □

### India was a ‘hot’ topic of discussion at the 125th National Hardwood Lumber Association Convention

**I**ndia was a ‘hot’ topic of discussion at the 125th National Hardwood Lumber Association Convention, which took place from October 4 - 6, 2023. The American Hardwood Export Council (AHEC) made a grand appearance at the highly anticipated NHLA convention where it delivered a crucial presentation on the first day of the convention. Of notable significance, AHEC contributed its expertise on global market access to the convention on the European Union’s Deforestation Regulation (EUDR), certification systems, and the overall environment for U.S. hardwood exports. Guest speakers included Phil Guillery, Rupert Oliver, and the AHEC Regional Directors. Whilst there was interest in markets all over the world, India was at the forefront with many AHEC members looking to expand their footprint in the country. □

## Amulya Mica organized a Dealers Meet at Gauhati Assam on 11th December 2023

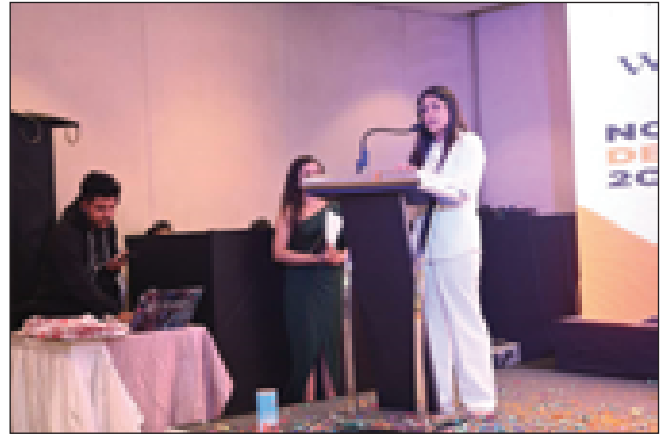

Amulya Mica organized a Dealers Meet on 11th Dec/23 at Hotel Taj Vivanta Gauhati Assam. More than 45 dealers from Gauhati and adjoining towns attended the event. From Amulya Mica, Mr. Neeraj Khandelwal Regional Manager (East), Mr. Sourav Pandey Head-WPC Division, Mr. Ravi Pandey Branch Manager Gauhati with his team and company's distributor Mr. Naveen Sharma & Mr. Amiya Ranjan Mallick of Amrita Laminates were present and greeted the guests. Company's MD Mr. Rakesh Agarwal, Ms Shailja Agarwal Marketing Director & Mr. Abhishek Agarwal Director were present to greet the delegates.

In the event, Mr. Neeraj Khandelwal along with his team presented company profile, its product and its USP which make difference from other products in the market. They explained Amulya Mica's Imperial Laminates collection like Synchronized Laminate 1.25mm, & Seven Wonder series collection its USP which makes us the leader in the market. Regarding Anti Scratch Laminate, to resolve the scratch problem, after much R &D by the team, we brought Anti Scratch laminate with high Gloss Level & Scratch Resistance. It is successfully tested in lab also. Further Mr. Sourav Pandey presented power point presentation of WPC/PVC products like PVC Laminates, Door Frame, PVC/WPC

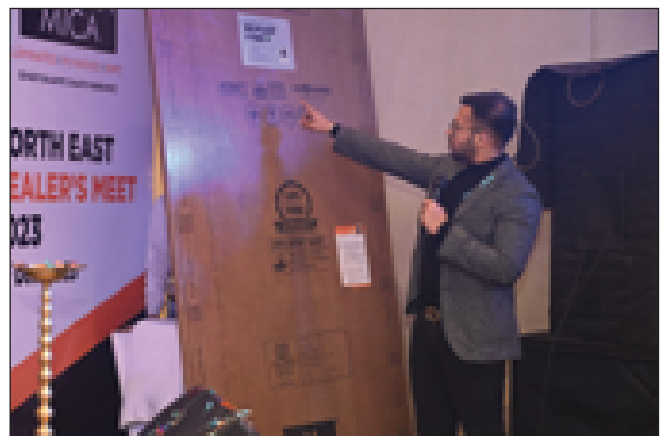



lead free door & CNC Jali designs etc. Ms. Shailja Agarwal also spoke Amulya Mica’s marketing policy & advantage of getting Udan Capital scheme for channel partners.

E0 Platinum Plus Plywood was launched by Mr. Abhishek Agarwal. In his presentation, he spoke about E0 Platinum Plus Plywood USP. Amulya Mica has bagged E0 plywood

certification that confirms to CARB regulations for its entire ranges of Plywood from Certification Services International, LLC California, USA. E0 grade plywood is one of the highest levels of emission standards with almost Zero Formaldehyde emission level. It helps in maintaining the indoor air quality safe with improved indoor air quality. Only few companies have this E0 certification, and we are one of them.

Speaking on the occasion, MD Mr. Rakesh Agarwal thanked all the dignitaries to be part of Amulya Mica family. He also recalled the old memories of his young age as he was born and brought up in Tinsukia, Assam. He started his business entrepreneurship in Tinsukia Assam. Assam is his “Karm Bhumi”. He wished Assam would flourish once again as it did during the year 70-80. Further he spoke about companies’ products, its USP which differentiate with other products, CSR activities, award & recognition. Amulya Mica is celebrating its successful journey of 19th years. He thanked for making journey wondrous over the 19th years and further committed of providing the best & high level of customer satisfaction.

The event was followed by a musical night and Dinner. □

## Rule change on logs could kickstart India trade

*Fumigation on ship or destination could give logs to India trade a boost*

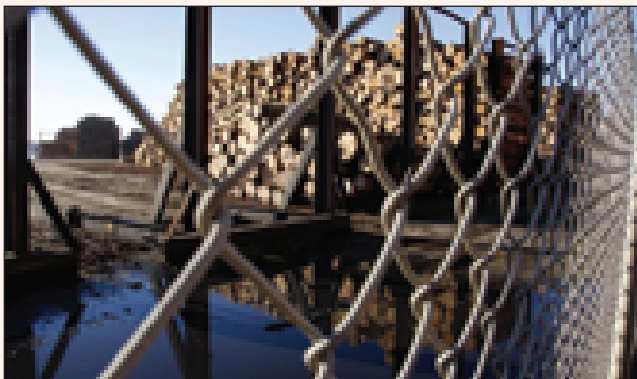

*An interim change to log export protocol to India opens the door for exporters to resume, subject to fumigating their cargo in India.*

A resumption of the log trade to India could be on the cards if a trial period granted by MPI proves to be successful. New Zealand has enjoyed a moderate level of export success in the past with log exports to India which reached their peak in value prior to covid-19 pandemic. But the implementation of new regulations in NZ banning the use of methyl bromide fumigant as a treatment for export shipments brought it to a stop.

Prior to this, trade volumes had peaked at 1.7 million cubic metres of timber a year valued at about \$250 million. This compares to annual Chinese exports of about 19m cubic metres, and 2m cubic metres to Korea a year. But the decision by the Environmental Protection Authority (EPA) to ban the use of methyl bromide as a fumigant in NZ bought trade came to a standstill. However Indian regulations stipulate methyl bromide must still be used, with no alternatives proposed.

Earlier this month MPI updated its phytosanitary

requirements for Indian log exports, allowing fumigation of logs in ships holds on arrival in India in lieu of treatment prior to sailing from NZ. The trial period has been granted from September 15 to October 31. But one forester said it was unlikely the sector would be rushing to the Indian market quickly.

“This represents a good opportunity, it’s a good result but there is still a lot of water to go under the bridge yet before we see a return to the earlier volumes to India,” Mark Proctor of TPT Forests said. He suspected most exporters would take a wait and see approach to the market which still represented a relatively small portion of NZ’s 20 million cubic metre a year export trade. “And it is not likely to return to that 1.7m cubic metre level quickly.” Shane Olsen, manager of plant exports at Biosecurity NZ, confirmed the update and said the interim option is an opportunity for bulk shipments of logs to resume following the prohibition of ship hold fumigation in NZ that took effect on January 1 this year.

“The interim option is available until October 31 this year to enable India to consider alternative treatment options for NZ logs to India,” he said in a written response. A recent trade delegation to India had resumption of a log trade on its agenda, subject to some compromises being reached around how the methyl bromide issue would be dealt with.

During the delegation’s visit minister for trade and export growth Damien O’Connor had acknowledged a joint effort to find a feasible alternative that allowed the importation of logs from NZ. NZ had also granted access to Indian mangos on the same trip. Forestry sector insiders have confirmed the export of unfumigated logs to India remains a risky proposition, with uncertainty over the exact cost an exporter’s log shipment may face on arrival in India to have the load fumigated. □

## Century Plyboards target revenue of ₹12000 crore by 2031



**P**lywood and decorative veneers major Century Plyboards (India) Ltd has set an ambitious target of achieving Rs 12,000 crore turnover by 2031 from about Rs 3600 crore in 2022-23. To achieve its Vision 2031, the company is implementing a Rs 2,000 crore capex plan, officials said.

The company's standalone revenue from operations for FY23 was Rs 3,620.65 crore, a growth of 20.65 per cent from the previous year. "We are aiming for Rs 12,000 crore revenue by 2031. Despite the challenging demand scenario and sustained

inflationary environment, the company strengthened its EBITDA by 4.4 per cent and profit after tax by 12.78 per cent during the year," Chairman Sajjan Bhajanka told shareholders at the AGM.

CenturyPly's plywood revenue increased by 27 per cent in the last fiscal, maintaining the company's market leadership position, he said. Non-plywood business revenues also grew by 13.52 per cent, which accounts for 44.43 per cent of the total revenue. These investments will be made in Andhra Pradesh, Tamil Nadu, and Punjab. The majority of the proposed investment will be directed towards MDF (medium-density fibreboard) and particle board, which have a combined revenue potential of 40 per cent of the company's turnover.

Addressing shareholders on outlook, Bhajanka said, "India is entering an exciting new phase. In the fiscal year 2022-23, we continued to outpace the global GDP growth of 3.2 per cent compared to the domestic growth rate of 7.2 per cent in FY23 - one of the few exceptions amidst the current worldwide economic slowdown. These marks one of the initial instances where India is significantly deviating from the global trend, and we anticipate this trend to continue sustainably driven by infrastructure push," he said. □

## After a decade, Cochin Port receives timber log shipments from Brazil

**A**fter a gap of 10 years, Cochin Port has received the first shipment of timber logs from Brazil for the requirement of Kerala's plywood manufacturing units. The vessel MV Chintana Naree has anchored with 15,000 tonnes of logs which mainly comprises Eucalyptus to be used for manufacturing plywood, said R Dileep, Director of Aaron Logistics, the handling agent of the ship. The port has extended all support to receive the cargo by offering incentives and ensured discount on vessel related charges and storage rent to reduce the handling cost. The trade unions have also extended support to reduce the handling cost so as to get a regular volume shipment which will benefit them to give regular employment to workers, Dileep said adding that the unloaded cargo will be moved by road to plywood manufacturing units.

### Plywood manufacturing in Kerala

In earlier days, the port used to get shipments of logs that had arrived mainly from Burma and African countries. Most of these cargos were of hard or heavy wood used for building material and furniture, he said. Babu Saidali, district treasurer of Plywood Manufacturers Association said the shortage of rubber based woods and its steep prices facilitated the association to go for log imports. Eucalyptus, silver oak, and meliadubia are some of the woods imported by plywood manufacturing units to reduce production cost.

Currently, the cost of rubber wood trees has reached ₹8500-9000 per tonne, making it unviable for companies to offer a minimum standard in plywood manufacturing. The association is also looking at options to import logs not only from Brazil



but from African countries, Sri Lanka where the prices are comparatively cheaper and ensure a viable business proposition for the plywood manufacturing industry, he said.

It may be recalled that United Planters Association of South India (Upasi) suggested a robust policy mechanism to integrate agro-forestry in Kerala plantations by allowing silviculture. This would make Kerala a leading timber producer and exporter.

According to the planters' body, Kerala was the leading State for tree plantation in 1980's and accounted for 10 per cent of tree plantation in the country. World's first scientific silviculture plantation was established in Kerala in 1840, which is popularly known to the world as "Connolly Plantation". However, over more than 40 years now, Kerala has been experiencing low timber production and has become a net importer to meet its own wood requirements. □

# India trade council joins forces with global body to boost furniture manufacturing

*The Trade Promotion Council of India (TPCI) and the World Furniture Confederation (WFC) have signed an MoU to create furniture industrial clusters in India. The agreement was made during the WFC's Annual General Meeting in Dongguan, China, attended by over 500 global business leaders.*

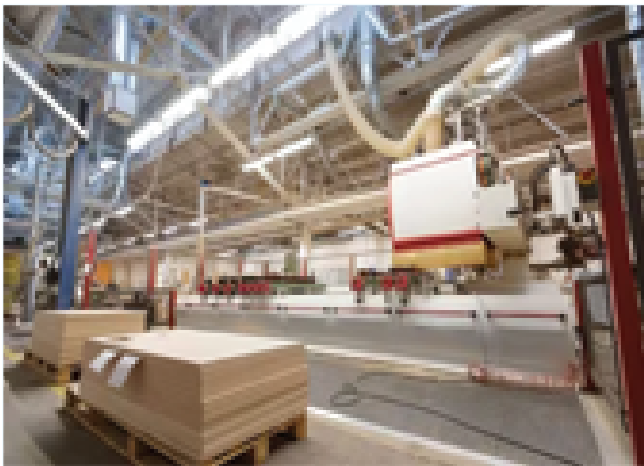

The Trade Promotion Council of India (TPCI) and the World Furniture Confederation (WFC) on Friday (August 18) inked a Memorandum of Understanding (MoU) aimed at establishing furniture industrial clusters within the country.

The MoU was signed during the Annual General Meeting of the World Furniture Confederation, held in Dongguan, China, and attended by over 500 business and industry representatives from around the globe.

Representing India at the event, Mohit Singla, Chairman of the Trade Promotion Council of India, joined hands with Mr. Xu Xiangnan, Chairman of the World Furniture Confederation and President of the China National Furniture Association.

This collaboration between TPCI and WFC is set to ignite a transformative journey for the organised furniture manufacturing sector in India. The main objective of the MoU is to facilitate the sharing of best practices and expertise, creating a seamless end-to-end ecosystem that fosters the growth of furniture manufacturing in the country.

Singla, commenting on this partnership, expressed his

optimism: “This MoU will promote engagement with global major furniture manufacturers, promote Make in India for domestic and export markets and is the first signal of global cooperation in the organised furniture sector for India. The organized furniture industry will help in efficient and cost-effective manufacturing at globally competitive prices.”

He also highlighted that this cooperation is expected to attract foreign direct investment (FDI), enhance India’s furniture exports, and reduce the country’s dependency on furniture imports.

Chairman TPCI also underlined the immense potential that the furniture sector holds for India: “Recent study of the potential sector has revealed great demand for plug and play clusters as the only possible means of achieving competitiveness, which is much desired for import substitution and export prowess.”

Expounding on the export prospects, Singla noted, “India enjoys zero duty on all considered products for export of furniture to the US market, which clearly underlines the big advantage to enter the US market.”

India’s current furniture industry is largely unorganised and fragmented, with a predominant focus on hand-crafted furniture. However, with this strategic partnership between TPCI and WFC, the nation is poised to tap into its latent potential and leverage its strengths to position itself as a formidable player in the global furniture trade.

The furniture industry worldwide accounts for a staggering USD 250 billion in trade, with both the EU and China exporting around USD 100 billion each.

Notably, the US, the largest importer of furniture, brings in a massive USD 72 billion worth of furniture imports annually. This presents India with a remarkable opportunity to amplify its furniture exports and emerge as a key player in the global market. □

*Readers are invited to send views, comments and suggestions if any, addressed to Editorial board  
We also invite your valuable Advertisement and Article to be published in the Journal.*

## “INDIAN WOOD & ALLIED PANELS”

Quarterly Journal - FIPPI

404, Vikrant Tower, 4, Rajendra Place, New Delhi-110008, India

Tel.: +91-11-25755649 (Direct), 25862301, Fax:+91-11-25768639

E-mail: [fippi@fippi.org](mailto:fippi@fippi.org), Website: [www.fippi.org](http://www.fippi.org)

## Amulya Mica participated in Dine with Designers (City Talk, Hisar) event on 2nd December 2023



**A**mulya Mica participated in Dine with Designers (City Talk, Hisar) event on 2nd Dec/23 at Hotel Lemon Tree Hisar. More than 80 architects from Hissar, Sirsa, Fatehabad and adjoining towns attended the event. From Amulya Mica, Mr. Ravi Gupta Punjab Regional Manager North-1 with his team Mr. Ankit Tiwari ASM, Mr. Ashutosh Modgill TSM and company's distributor Mr. Naman Gupta of Kumar Plywoods Hisar were present and greeted the architects.

In the event, Mr. Ravi Gupta along with his team and Mr. Naman Gupta presented company profile, its product and its USP which make difference from other products in the market. They

explained Amulya Mica's Imperial Laminates collection like Synchronized Laminate 1.25mm, exact replacement of natural veneer in look and touch, its cost effectiveness and eco-friendly USP which makes us the leader in the market. Further they have also presented power point presentation of other products like cladding, Amulya Anti Scratch laminate, PVC Laminates, Door Frame, PVC/WPC lead free door and newly launched E0 Platinum Plus Plywood. They explained about E0 plywood certification that confirms to CARB regulations for its entire ranges of Plywood from Certification Services International, LLC California, USA. E0 grade plywood is one of the highest



levels of emission standards with almost Zero Formaldehyde emission level. It helps in maintaining the indoor air quality safe with improved indoor air quality. Only few companies have this E0 certification and we are one of them. Further they presented companies CSR activities, plantation drive and its award and recognition “Most Trusted Brand” in the market.

In the event the Guest of Honor were Ar. Kashish Gupta, Ar. Ajender Beniwal, Ar. Sunny Garg, Ar. Varun Kumar, Ar. Nitin Kumar, Ar. Pankaj, Ar. Akshat Mehta and Ar. Paramveer.

Architects also presented their profile and project works done by them. The exhibitor awarded trophies to a few architects on different parameters and Amulya Mica awarded the trophy to a few selected Architects on behalf of the exhibitor. The event was followed by a live band/cocktail and Dinner.□

## BIS Announces Revised Concession Fees for MSMEs and Women Entrepreneurs

**P**ramod Kumar Tiwari, Director General of the Bureau of Indian Standards (BIS) has announced a revised concession fee on certification/minimum marking fee for Micro, Small and Medium Enterprises (MSMEs) during the 77th BIS foundation day.

Tiwari highlighted that a concession of 20 per cent is being given to the small and medium enterprises. He added that micro-scale units are being granted an 80% concession on the certification/minimum marking fee.

For women entrepreneur of small and medium scale enterprises, a concession of 50 per cent will be provided by the BIS, he further added. This was announced during a seminar on “Dialogue for Strengthening of Quality Eco-system in India” on the occasion of 77th BIS foundation day at Bharat Mandapam, New Delhi.

The Director General, during his welcome, addressed the roles and activities of BIS. He said that BIS, the National Standards Body of India, formulates and publishes Indian Standards. It enforces Conformity Assessment Schemes, manages laboratories for Conformity Assessment, and oversees Hallmarking implementation.

He also highlighted that the organization focuses on consumer empowerment, conducts quality assurance capacity-building programs, and represents the country in International Organization for Standardization (ISO) and International Electrotechnical Commission (IEC).

Piyush Goyal, Union Minister of Commerce & Industry, Consumer Affairs, Food & Public Distribution and Textiles, also attended the seminar and during the presidential address he stated that there is an important role of Industrial Association in providing information for preparing Standards on the products.

Goyal also mentioned that BIS will prepare our own Indian Standards of all the products and will not depend foreigner Standards.□

## NeXTimber produces first CLT panel, begins taking orders



*The first CLT panel pressed at the NeXTimber facility.*

**T**imberlink has pressed its very first cross-laminated Timber (CLT) panel, marking another significant milestone in the construction of what is said to be Australia’s only combined CLT and glue-laminated timber (glulam) radiata pine mass timber facility. Back in August, the NeXTimber facility in Tarpeena, Australia, produced its first glulam beam.

David Oliver, Timberlink chief marketing, sales and corporate affairs officer, said: “The entire team has been working towards this moment since we announced construction of the facility in 2020. To see the hard work of so many come to fruition is very rewarding.”

Patrick Dark, Timberlink CLT/glulam operations manager, said: “There was such an air of positivity when the panel came off the line. Everybody who has been involved in the installation, testing and commissioning of our NeXTimber equipment should be proud of what we have accomplished.”

According to Timberlink, the newly commissioned CLT line can produce panels up to 16m-long and 3.5m-wide, and will unlock the capability to manufacture mass timber building products in Australia.

Mass timber products like CLT and glulam offer an exciting alternative to traditional construction materials and can help to reduce the embodied carbon of a project.

The NeXTimber by Timberlink team are now accepting orders for CLT and glulam as the facility is scheduled for full production by the end of October.□

## Mato Grosso aims to expand wood exports to larger global markets



Sales of wood from Mato Grosso to other countries reached US\$70.9 million this year. Compared to other Brazilian exporting states, Mato Grosso occupies 4th place in the national ranking, shipping 68,677 tons of forestry products abroad, from January to September 2023. Almost half of all municipalities in Mato Grosso have industries in the forestry sector. In total, there are 66 cities or 46.8% of the 141 municipalities in Mato Grosso with companies in the sector, with log production standing out, especially in the municipalities of Colniza and Aripuanã, which lead with a share of 0.6% and 18%, respectively, in state production, according to the Brazilian Institute of Geography and Statistics (IBGE).

In the global context, China and India stand out as important consumers of wood products, extracted from areas with sustainable forest management projects. This year, until September, India acquired 38,101 tons of wood from Mato Grosso for the amount of US\$ 20.5 million and China imported 8,964 tons of the product for a total value of US\$ 6.8 million, according to statistics from the Agrostat system of the Ministry of Agriculture and Livestock (Map).

In this same period, Brazil sent 6 million tons of wood abroad, resulting in US\$ 3 billion in revenue. Ahead of Mato Grosso, the largest export balances of forest products in 2023 are attributed to Santa Catarina (US\$ 1 billion), Rio Grande do Sul (R\$ 436.7 million) and Pará (US\$ 177.1 million), including native wood and wood from planted forests in all states.

“It is part of Cipem’s strategic planning to increase wood exports to these two Asian countries, since Mato Grosso has the variety, quality, volume and good origin of forestry products to meet international consumer demand. China is very interested in our products and will help us organize a new mission next year”, explains the president of the Center for Wood-Producing and Exporting Industries of Mato Grosso (Cipem), Ednei Blasius. With a focus on promoting and expanding business, entrepreneurs from the forestry sector in Mato Grosso will participate on the 21st and 22nd of this month in the Global Wood Forum, in Macau, China. The president of Cipem leads the business delegation to Asia.

Next year, entrepreneurs from the forestry sector in Mato Grosso will also participate in a business fair in Nantes, France, in addition to the 10th edition of the International Furniture and Wood Industry Fair (ForMóbile), from the 2nd to the 5th of July, in Sao Paulo. Blasius also commented that wood exports from Mato Grosso to India have focused on teak – reforestation wood, and that the state needs to increase shipments of native wood from sustainable forest management.

The president of Cipem met this week with the team from the Ministry of Development, Industry, Commerce and Services (MDIC), as well as the minister and Economic and Commercial counselor at the Chinese Embassy in Brazil, Shao Yingjun, and the director of the Commercial Division of India, Suraj Jadhav. All meetings were held with a focus on the opening and commercial expansion of the forest-based sector in Mato Grosso. □

## Japan witnesses a great rise in mass timber

According to iwfatlanta.com, the worldwide market for mass timber buildings and structures continues to expand and many are rising in Japan, often combining modern construction techniques with traditional Japanese joinery. The latest is the Obayashi Port Plus building in Yokohama, the port city that serves Tokyo. Completed last year, Port Plus is a fully wooden-framed, fire-resistant high rise composed mainly of 540 wooden rigid cross-joints that are 9.2 feet wide by 13 feet tall.

“We believe that the utilization of forest resources will lead to the realization of a low-carbon society and the revitalization of local communities,” Shinji Yamasaki, chief engineer in Obayashi’s timber construction promotion department, said in an emailed statement to Bloomberg which reported on the new structure. “The company is committed to wooden construction and actively forming alliances across the forestry industry,” Bloomberg reported Yamasaki adding.

The news story went on to say that “the building’s main technical innovation is also its architectural highlight: The rigid cross-joints effectively combine traditional columns and beams into single prefabricated units, composed of LVL wrapped in multiple layers of fire-resistant plasterboard and a finishing layer of wood. Glued-in rods and nuki joints, a traditional Japanese carpentry technique, strengthen and connect the units. No adhesives are used in the larch core, so the timber can be reused at the end of the building’s life.”

Japan is aiming to cut its carbon emissions by 46 percent by 2030 from 2013 levels and achieve carbon neutrality by mid-century, the report says. The use of mass timber in new construction is a big part of the effort and for Obayashi the Port Plus building is as much a learning experience as it is a functioning structure. “We learned that a building can be fully made out of wood,” said Yamasaki. □

## Samling Timber Malaysia Signs MOU with Australia-Based Loggo IP to Develop Engineered Wood Products in Sarawak



Pat Thornton, founder of Loggo IP (left) and Lawrence Chia, CEO of Samling Group, (right) signing the MoU, witnessed by STIDC advisor Datu Hashim Bojet in the middle (Image: New Straits Times)

Samling Timber Malaysia has reportedly signed a MoU with Loggo IP to use the latter's "patented engineered wood technology to develop small diameter true rounds or peeler cores", as described by Lawrence Chia, Samling Group's CEO.

Loggo IP is an Australia-based developer of engineered wood products, recognised for using planted wood species such as Acacia and Eucalyptus for building systems aimed at housing, commercial and government buildings, three-storey walk-ups, shop top housing as well as mid-rise and multi-residential apartments blocks. According to Chia, every year, millions of peeler cores are produced as 'waste' from plywood production.

These were largely used in low-value recovery options such as packaging and as fuel for thermal energy processes.

"However, in a world 'first', Loggo has developed and patented three versatile engineered wood products as well as columns and each can be made from low value forest 'thinning' or peeler cores. Two of these beams can use Samling's ply as a web," Chia said, as quoted by various news agencies.

Chia signed the MoU with Loggo IP's CEO, Pat Thornton, who commented: "As the world shortage of timber hits home, we are convinced Samling, long respected globally for its high standards of sustainable forest management, can develop these cost-competitive systems across South East Asia and beyond."

Loggo's low-tech, minimal processing and set-up costs and the economic advantage of the low-value plywood by-products are a green and sustainable way to increase returns, according to Thornton. The Sarawak Timber Industry Development Corporation (STIDC) was also there to witness the MoU signing.

"STIDC is very happy that the industry players are taking initiatives to develop engineered wood products using planted wood in Sarawak. This is aligned with our vision to utilise more planted logs for high-value wood-based products like engineered wood," said Datu Haji Hashim Bojet, advisor of STIDC.

This MoU is also aligned with STIDC's vision to increase the use of mass engineered timber like laminated lumber veneer (LVL) and cross-laminated timber (CLT). Under its sustainable forests mandate, Samling currently manages around 1.2 million hectares of forest land and 190,250 hectares of gross plantable forest plantations in Malaysia. □

## SPAN FLOORS Introduces Vulcan TG 9, Wood Soffit Panelling



Span Floors, a leading brand of wooden flooring in India and a foremost provider of premium wood flooring, cladding and decking solutions, proudly introduces its latest innovation, Vulcan TG 9 Wood Soffit Panelling. Crafted for luxury residential facades, Vulcan TG 9 combines sophistication with durability to elevate the aesthetic appeal of homes. A key feature of Vulcan TG 9 is the application of Span Floors' proprietary coating, Protector oil.

This advanced coating not only shields the timber from environmental factors but also imparts a long-lasting, ultra-low maintenance finish. Homeowners can enjoy the beauty of Vulcan TG 9 without compromising on ease of care.

Vulcan TG 9 by Span Floors boasts a distinctive and elegant minimalist design that adds a unique charm to residential exteriors, be it the modern contemporary or classic. The premium wood panelling is not only visually appealing but also ensures longevity and resilience. With a focus on durability, Vulcan TG 9 comes with an anti-termite and fungal decay warranty, providing homeowners with peace of mind and a lasting investment.

The Vulcan TG 9 wood panelling is meticulously crafted to provide a unique and elegant look to residential exteriors. Ideal for luxury homes, this premium wood soffit enhances the architectural appeal, creating a sophisticated and timeless ambience.

Beyond its aesthetic allure, Vulcan TG 9 is built to last, offering homeowners peace of mind with an anti-termite and fungal decay warranty. This commitment to durability ensures that the wood panelling stands the test of time, maintaining its pristine appearance for years to come. □

## India, New Zealand discuss measures to cut trade barriers, promote investor-friendly environment

With the aim to reduce trade barriers and promote a more investor-friendly environment, Indian Minister of Commerce Piyush Goyal met his counterpart from New Zealand Todd McClay in New Delhi on December 19.

During the meeting, both the ministers recognised the importance of trade facilitation and discussed measures to streamline trade processes, reduce trade barriers, and promote a more conducive environment for businesses and investors from both nations, an official statement said.

The trade minister of New Zealand appreciated the efforts made by India to sort out the issue related to export of wooden logs to India.

“They highlighted the need to deepen engagement in sectors such as agriculture, forestry, pharma, connectivity, education and tourism,” it said.

To strengthen the trade and economic relationship, ministers expressed the need to increase engagement between both the



countries under a collaborative approach that engages officials from across relevant departments and the private sector.

The bilateral trade between the two countries stood at USD one billion in 2022-23. □

## Bamboo trees planted to help raise water table: Delhi LG VK Saxena



Delhi LG VK Saxena

During a zonal council meeting in Amritsar, Lieutenant Governor VK Saxena highlighted the successful practices and innovations adopted by Delhi. These include bamboo plantation to increase oxygen levels, using refuse-derived fuel by cement and paper industries, and the use of inert and construction debris for filling material. Saxena also mentioned the use of partial gravitational desilting technology to clean drains and the Yamuna river; as well as the adoption of blockchain technology by Delhi Police for efficient investigations and justice delivery. These interventions have helped address long-standing issues such as pollution and waste disposal.

In the northern zonal council meeting in Amritsar earlier this week, lieutenant governor VK Saxena made a presentation on good practices and innovations adopted by Delhi in recent times. Officials said the LG spoke about bamboo plantation to augment oxygen, use of refuse derived fuel (RDF) by cement

and paper industry, and inert and construction debris by National Highways Authority of India as filling material, partial gravitational desilting, and boats fitted with rotating cutters to clean the Najafgarh drain and the Yamuna in Delhi.

Saxena told the gathering that these interventions had helped in solving long-standing problems such as pollution in the Yamuna and disposal of municipal solid waste and debris to an extent.

The council comprises Union territories and states of Jammu and Kashmir, Ladakh, Delhi, Chandigarh, Haryana, Punjab, Himachal Pradesh and Rajasthan, with Union home minister Amit Shah as its chairman.

According to officials, the LG informed the delegations that about 3.2 lakh bamboo trees had been planted across Delhi. “He underlined that bamboo trees emit 30% more oxygen than other plants, consume less water and help raise the water table. These trees, despite scepticism of the experts, had grown up to 10-20 feet during the last eight months,” said an official.

Saxena also talked about the partial gravitational desilting technology to clean the Najafgarh drain and the Yamuna, which, he claimed, was cost-effective and innovative.

“For disposal of waste at the landfills in the capital, Saxena said how the municipal corporation was selling the refuse-derived fuel waste to the cement and paper industry as fuel for their boilers and plants,” said an official at the LG’s secretariat.

The adoption of block chain technology by Delhi Police was an innovative first in the country for speeding and fool-proofing the investigation and subsequent justice delivery, he said. □

# ‘Will boost India’s mission for clean, green growth’: PM Modi lauds Assam govt’s mega plantation drive

*PM Modi said the exercise will also further enhance the green cover of Assam*



Prime Minister Narendra Modi has hailed the Assam government’s mega plantation drive, stating it will boost the country’s mission for clean and green growth, besides providing long-term benefits of environmental protection and improving the health of people. He said the exercise will also further enhance the green cover of the scenic State.

In a letter to Chief Minister Himanta Biswa Sarma on the State’s ‘Amrit Brikshya Andolan’, the PM wrote: “The idea

of planting one crore saplings across Assam is admirable and laudable.”

Modi said several references in the nation’s culture and literature reflect the importance of trees and forests, and quoted a couple of Sanskrit lines on how trees purify the air and help in driving away diseases. He maintained that bringing together ‘prakriti’ (nature) and ‘pragati’ (development) has been the hallmark of the development model of “New India”.

“While we have been the fastest growing economy, we have also been perhaps the only major nation to meet committed climate targets,” the PM said. He said initiatives like this plantation drive will further bolster the national mission for clean and green growth.

“It will also lead to several long-term spin-off benefits for environment protection and in improving the health of people,” he added.

Mentioning the rich biodiversity and diverse ecosystems in Assam, Modi said, “The plantation of saplings on private and community-owned lands will go a long way in enhancing the green cover in the scenic state.”

The involvement of the local communities in the drive will “foster the spirit of ‘Jan Bhagidari’ (people’s participation) and bring a sense of ownership and environmental stewardship among the people”, the Prime Minister added.

The State government is undertaking a drive to plant one crore saplings across the State, during which it is also seeking to create nine world records in different segments concerning the exercise. □

## Request for Extension of QCO for Wooden Based Boards

Shri Jaydeep Chitlangia Secretary General FIPPI had a meeting with Director General BIS and Joint Secretary DPIIT, Ministry of Commerce & Industry wherein a letter was submitted, on behalf of FIPPI members requesting for extension of implementation of QCO for Wooden based boards, Plywood and Wooden flush door shutters and Resin treated compressed Wood Laminate, and for creating a new standard for non confirming products under the various standards.

The DG BIS gave a patient hearing and appreciated for mentioning the points raised in our letter and gave us assurance that they would certainly look into the matter as suggested by us to create a new standard with the nomenclature BIS UTILITY grade. He urged all the associations to work closely in facilitating the implementation of BIS registration for Wood-based Industries which would help in the nation building. Shri Jaydeep Chitlangia briefed Mr Arun Kumar Head (Civil Engineering) and other related officers who are looking after

the BIS specification and explained in details the technicalities and the generic of wood and the problems faced by the wood panel industries and the need for a separate grade, as requested in our letter. The officials assured their cooperation to address the issues in the coming months and would bring in awareness by helping in Research & Development in the various clusters of the Industry.

The Joint Secretary DPIIT was also sympathetic to our letter and requested all the stakeholders to facilitate with DPIIT and BIS and work closely with them in implementing the QCO Order. The request letter submitted by FIPPI for extension of implementation of QCO is most likely to get extension as we could understand from the respective officials and we will soon come to know the outcome of our request in due course. Shri Jaydeep Chitlangia also enquired about the Representation for formation of Development Council which we had submitted. The Director informed that they are looking favourably into the request for formation of Development Council. □

# India Aims For Global Leadership In Quality Products, 'Zero Defect, Zero Effect' Takes Center Stage



Union Minister Piyush Goyal highlighted the government's focus on Quality Control Orders (QCOs), and the 'Zero Defect, Zero Effect' motto, transforming the perception of 'Made in India' on a global scale. India is on a determined mission to establish itself as a world leader in delivering high-quality products adhering to the most stringent global standards. The supply of quality products at competitive rates is a cornerstone of the broader agenda to propel India into the ranks of developed nations by 2047.

The government is taking concrete steps to ensure that 'Made in India' becomes synonymous with quality, capturing the admiration of both Indian and foreign consumers alike.

The emphasis on a balanced market, considering the interests of producers and consumers, is evident in the strategic focus on Quality Control Orders (QCOs). These orders mandate that specific products adhere to the prescribed norms of the Bureau of Indian Standards, instilling confidence in consumers

regarding the reliability, safety, and high quality of the products.

To meet the evolving demands of consumers in both domestic and international markets, finding a delicate equilibrium between product quality, price, and innovation becomes crucial. This holistic approach is seen as imperative to cater to the expectations of an increasingly discerning customer base.

The government's strategic focus extends beyond the domestic market, aiming to develop a robust quality ecosystem that ensures the production and promotion of safe, reliable, and superior-quality goods. Simultaneously, there is a concerted effort to boost the export of Indian products on the global stage. The transformative impact of Quality Control Orders (QCOs) is striking. Before May 2014, a mere 14 QCOs covering 106 products were in place.

However, the government's commitment to quality is evident in the expansion of this list to 148 QCOs, now encompassing 653 products, including household items like ACs, toys, and footwear. This expansion has significantly accelerated the 'Make in India for the World' mission.

Quality Control Orders have emerged as a driving force behind the 'Make in India for the World' initiative, resulting in the export of various quality-controlled products surpassing their import levels. Products such as cast-iron items, solar DC cables, door fittings, ceiling fans, helmets, smart meters, hinges, air coolers, and air filters are now exported at higher rates than they are imported. Notably, around 25 QCOs apply to products where exports exceed imports, showcasing the success of this quality-centric strategy. □

## Greenpanel India's Innovative outdoor marketing campaign in Ayodhya



Greenpanel, India's largest wood panel manufacturer, has launched an innovative in the upcoming spiritual hub, Ayodhya. This campaign marks a significant milestone for the brand, underscoring its cultural relevance and commitment to excellence. As a part of this two-month-long

campaign, Greenpanel has strategically displayed wall wraps on the roads connecting Ayodhya Highway catering to the high footfall.

Welcoming the visitors en route, the billboards have been displayed along the Lucknow to Ayodhya, Basti to Ayodhya and Gorakhpur to Ayodhya route. The campaign reinforces Greenpanel's position as India's No.1 MDF company. Ayodhya holds immense cultural and historical significance for the people of India. Launching an outdoor marketing campaign in the city is Greenpanel's way of being a part of this momentous occasion. The campaign portrays a spiritual side of the brand - the one that stands strong with the country and embraces the plurality of its culture.

With this campaign, Greenpanel aims to reach its target audience while positioning the brand as not only a leading MDF manufacturing brand but also a highly culturally relevant and connected company. outdoor marketing campaign. □

# 2024 Events Calendar

## INDIAWOOD 2024

**Date:** February 22-26, 2024

**Venue:** Bangalore International Exhibition Centre, Bengaluru

**Website:** <https://www.indiawood.com/>

### Event Highlight:

INDIAWOOD - Asia's Biggest Exhibition, where innovation meets expertise, and technology shapes the future of the industry.

### Machinery & Technology at Its Finest:

- Explore state-of-the-art machinery transforming solid wood into exquisite furniture pieces and decorative elements.
- Experience revolutionary methods for enhancing wood surfaces and achieving impeccable finishes.
- Discover a vast array of specialized tools and accessories crucial for furniture production and woodworking.

### Materials & Supplies Galore:

- Explore the latest in adhesives, coatings, and chemicals for optimal wood finishing and protection.
- Witness an assortment of wood types, veneers, doors, and decorative surfaces to elevate your designs.
- From plywood, laminates to MDF, discover a range of interior panels for diverse furniture applications.

### Fittings, Hardware & Components:

- Find an extensive range of fittings, built-in parts, and hardware systems essential for cabinetry and furniture assembly.
- Discover high-quality materials for crafting cabinetry, kitchens, offices, and modular furniture. □

## MIFF 2024

**Date:** March 1-4, 2024

**Venue:** World Trade Centre Kuala Lumpur (WTCKL) and Malaysia International Trade & Exhibition Centre (MITEC)

**Website:** [www.miff.com.my](http://www.miff.com.my)

### Event Highlight:

The Malaysian International Furniture Fair (MIFF) has spearheaded the furniture trade scene for years. Every year, quality exhibitors and buyers from all over the world converge on the global stage. MIFF welcomes over 6,000 quality buyers from over 140 countries. In recent years, the fair has drawn more and more influential buyers who purchase in bulk on the spot. From high-quality modern and contemporary furniture to tried-and-true classics, over 600 international and Malaysian exhibitors show off their latest collections and designs for bedroom, living areas, kitchens, bathrooms, children office, commercial foyers, hotel lounges and outdoor living. MIFF provides a robust B2B platform for buyers to interact with suppliers, connects people with innovative products and a ready market, and also organises free-entry seminars with top industry speakers to provide insights, discuss coming trends and share market intelligence. □

## EXHIBITION OUTLOOK 2024

**Date:** March 28-31, 2024

**Venue:** Canton Fair Complex, Pazhou, Guangzhou

**Website:** [www.interzum-guangzhou.com](http://www.interzum-guangzhou.com)

### Event Highlight:

CIFM/Interzum Guangzhou, one of Asia's premier furniture manufacturing events, will be held at the Canton Fair Complex in Guangzhou from March 28-31, 2024. With 1,200 exhibitors from around the world occupying 160,000 sqm of space, the event expects to attract more than 150,000 trade visitors and offer international exhibitors unique access to the Chinese market and beyond.

### Seizing China's 'dual circulation' opportunities

According to statistics, the global furniture market passed the US\$600

billion mark in 2022 and is expected to continue growing at a compound annual growth rate of five percent over the next four year (2023-2026). As the global furniture market continues to grow, CIFM/Interzum Guangzhou is seizing the opportunities presented by China's 'dual circulation' strategy to actively facilitate international brands' entry into the vast Chinese market-which ranks first in the world in terms of furniture production, consumption and export-while promoting the globalisation of domestic brands.

### Combined forces of old and new participants

Leading international brands are returning to the Chinese market with confidence, while new participants are invigorating the show with fresh perspectives, energy and innovative products. Nearly 200 leading international companies have confirmed their participation in the edition in 2024. Interzum Guangzhou, a member of the interzum brand family, offers international exhibitors unparalleled. □

## XYLEXPO 2024

**Date:** May 21-24, 2024

**Venue:** Fiermilano-Rho

**Website:** [www.xylexpo.com](http://www.xylexpo.com)

### Event Highlight:

The 28th edition of Xylexpo, the biennial international exhibition of woodworking and furniture technology, is moving back to May. The exhibition will be held at Fiermilano-Rho in the "east side" halls, to simplify the mobility of Italian and international operators who are expected to attend in high numbers. People from all corners of the globe in Xylexpo 2024 can capture technological solutions in real time and meet own needs. It will be great opportunity to accelerate business dynamics when Italian woodworking machinery market, being one of the biggest in the world. Xylexpo 2024, built up on its international integrity with positive benchmark scenario deriving from its last edition – 275 exhibitors within 18,500 sqm net area to 16,500 unique visitors – will be fully committed to light again the stage where innovative ideas can turn into a competitive edge. □

## DOMOTEX ASIA / CHINAFLOOR 2024

**Date:** May 28-30, 2024

**Venue:** National Exhibition and Convention Center (NECC)

**Website:** [www.domotexasiachinafloor.com](http://www.domotexasiachinafloor.com)

### Event Highlight:

2024 marked DOMOTEX asia/CHINAFLOOR's 26th edition. What began as a small exhibition has risen to one of the fastest growing flooring trade exhibitions worldwide. As part of the DOMOTEX trade show portfolio, DOMOTEX asia/CHINAFLOOR is the ideal flooring platform in the Asian-Pacific region, attracting important industry brand. Top quality industry professionals from the emerging Asian markets and from around the world attend the show each year and have utilized the event as their ideal platform to purchase flooring products, from partnerships locate suppliers and manufacturers, and networks with industry leaders. The exhibition product categories include Wood Flooring, Bamboo and Cork Flooring, Flooring Technology, Machine-Made Carpets, Hand-Made Carpets, Carpet Technology, Resilient Flooring, Sports Flooring & WPC. □

## IWF 2024

**Date:** August 6-9, 2024

**Venue:** Georgia Wood Congress Center

**Website:** [www.iwfatlanta.com](http://www.iwfatlanta.com)

### Event Highlight

The International Woodworking Fair® is North America's largest woodworking technology and design trade show and conference and one of the top destinations for the global woodworking sector. IWF

delivers the latest solutions in architectural woodwork, cabinetry, flooring, furniture manufacturing, engineered products, doors, windows, machinery, tools, metals, plastics and more. IWF is where the woodworking business does business. □

### **FURNITURE CHINA 2024**

**Date: September 10-13, 2024**

**Venue: Shanghai New International Expo Centre (SNIEC)**

**Website: [www.furniture-china.cn/en](http://www.furniture-china.cn/en)**

#### **Event Highlight:**

The first edition of China International Furniture Expo (also known as Furniture China) was co-hosted by the China National Furniture Association and Shanghai Sinoexpo Informa Markets International Exhibition Co., Ltd in 1993. Since then, Furniture China has been held in Shanghai in the second week of every September. Since its establishment, Furniture China has been successfully held on 28 occasions making common growth and progress with the furniture industry in China. At the same time, it has transformed from a pure B2B offline trade platform to a comprehensive platform integrating export, domestic sales, B2B2P2C online and offline, original design showcase and a trading and design feast with “exhibition-store-linkage”. Overseas attendance at Furniture China 2023 grew by 13.2%, exceeding the record high. □

### **CIFF / WMF 2024**

**Dates: September 11-14, 2024**

**Venue National Exhibition and Convention Centre (Shanghai, Hongqiao)**

**Website: [www.ciff.furniture](http://www.ciff.furniture) / [www.woodworkfair.com](http://www.woodworkfair.com)**

#### **Event Highlight:**

CIFF Shanghai, the International Furniture Fair in China, which takes place annually at the National Exhibition and Convention Center (Shanghai Hongqiao) Exhibition situation of CIFF Shanghai 2023 has shown that 1,500 exhibitors arranged across 340,000 square metres, attended by 93,474 trade visitors, 84,611 of whom came from China and 8,863 from abroad. CIFF Shanghai has established itself as the indispensable platform for penetrating the Chinese market as it is capable of narrating the market through its trends, complexities (cultural and otherwise), and players and positioned as an essential vehicle for meeting distributors and building a local customer base. In view of the rising demand in innovative technologies across the entire supply chain of furniture production and woodworking industry, Shanghai International Furniture Machinery & Woodworking Machinery Fair (EMF) has been collocated with CIFF (Shanghai) once a year at Shanghai Hongqiao, China since 2018 to serves as a one-stop sourcing platform for the whole industrial sector and a key networking hub for technological developments and business ideas. In 2023, the show has gathered exhibitors from around the world to showcase the full spectrum of cutting-edge equipment and machinery, as well as total solutions. □

### **TIWF 2024**

**Date: September 18-20, 2024**

**Venue: IMPACT Exhibition and Convention Centre, Bangkok**

**Website: <https://thailandwoodworking.com/>**

#### **Event Highlight:**

The value of Thailand’s wood exports achieved a milestone in 2022, totalling 104 billion Thai baht. In the first four months of 2023 alone, export value has already surged to 36.4 billion Thai baht, reflecting a remarkable 5.31 percent increase compared to the same period last year. Thailand’s wood product exports are divided into five segments, namely processed wood, fibreboard, plywood, furniture and other wood products. Processed wood, fibreboard, and plywood accounts for 73 percent of total exports, while furniture and other wood products accounts for the remaining 27 percent. According to Thailand’s 2021 woodworking machines, valued at US\$70.9 million. Imports are expected to rise as Thailand continues to rely on imports of machinery and technology in order to produce and export better quality wood products. It is against the above mentioned backdrop, that an event like Thailand Exhibition 2024

(TIWF 2024) is staged to provide Thailand and the surrounding Southeast Asian woodworking industry, with a dedicated face-to-face international forum to meet, discuss, exchange views, gain new knowledge, update on trends, forge new business partnerships and network, while at the same time address sustainability issues impacting the environment. The show will take up over 5,000 sqm of exhibition space, with over 150 exhibiting companies and 4,000 local and international attendees coming from the entire spectrum of the woodworking and furniture supply chain sectors. One unique highlight of the event is its Hosted Buyers and Business Matching Program designed to identify and invite key buyers from Southeast Asia to attend. This program presents exhibiting companies with the opportunity to meet directly with key decision makers seeking solutions and answers to improve their production and manufacturing efficiencies. Locally, the exhibition is hosted by Thailand’s Ministry of Natural Resources and Environment as its Host Organization. The event’s strategic partners include the Thai Forestry Industry Organisation and the Kasetsart University’s Forestry Faculty. In an initiative to uplift the standards of Thailand’s wood industry, especially those located in the provinces, the show is working with its strategic partners to conduct a series of educational and best practice workshops in these provinces, prior to the actual TIWF event. TIWF 2024 is also supported by related wood industry associations such as the Thai Furniture Association, Thai Timber Association, the Federation of Thai Industries, and Thai Hevea Wood Association to name a few. On the international support front, organisations such as Americans Softwoods, American Hardwood Export Council, French Timber, Malaysia Timber Council, Singapore Timber Associations, Wood Technologist Association (India), and Vietnam Chamber of Commerce and Industry have all confirmed their supports, and looking to participate in this event. TWF 2024 has also received plans for a ‘Made in Germany’ Pavilion supported by Federal Ministry for Economic Affairs and Climate Action. The German Exhibitor Pavilion is subjected to officials confirmation, including those of other European Exhibitor Pavilion groups. □

### **IFMAC WOODMAC INDONESIA 2024**

**Date: September 25-28, 2024**

**Venue: JI EXPO Kemayoran**

**Website: [www.ifmac.net](http://www.ifmac.net)**

#### **Event Highlight:**

IFMAC WOODMAC Indonesia will be held at JI EXPO Kemayoran, Jakarta on September 25-28, 2024. For visitors, they can discover and experience the latest innovations and technology for furniture manufacturing and woodworking industry through IFMAC WOODMAC Indonesia. For exhibitors, the exhibition can help them showcase product, network, and present company and businesses to the emerging market of Indonesia and the South East Asia Region. The exhibiting products of IFMAC WOODMAC Indonesia include Wood, Panel and Furniture Tools & Machinery. Veneer, Films, Decorative, Furniture Fittings, Locks & Accessories, Adhesives, Abrasive, Paint and Coatings, textile, Upholstery & Bedding. □

### **MYANMAR WOOD 2024**

**Dates: December 13-16, 2024**

**Venue: Yangon Convention Center**

**Website: [www.chanchao.com.tw/en/expoDetail.asp?id=FWDWMMR2024](http://www.chanchao.com.tw/en/expoDetail.asp?id=FWDWMMR2024)**

#### **Event Highlight:**

The next edition of Myanmar Wood will be held in Yangon Convention Center from December 13-16, 2024. The exhibit categories of Myanmar Wood include Woodworking machinery plant & accessories for production of sawn timber, veneer, particleboard, MDF, OSB, LVL, plywood & panels, kiln drying & related timber technologies, joinery machinery, machinery for the furniture industry, wood-based panels & veneered products, manufacturers of upholstered products. Machinery & lines for fishing, Handling equipment, tooling, woodworking tools, hard tools, portable power tools; Fittings & accessories, dust extraction equipment; Woodworking materials & consumables etc. □

**DURO**  
**NATURE'S SIGNATURE**<sup>®</sup>  
PREMIUM VENEERS & PLYWOODS

**BOHEMIA**  
Textured Veneer Panels

# Intricacies of Wood in a Multifaceted Style

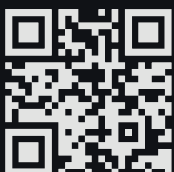

Duroply Industries Limited  
BLOCK BOARD · PLYWOOD · VENEERS · DOORS

+91 7290049965 | enquiry@duroply.com | www.duroply.in  
113 Park Street, North Block 4th Floor, Kolkata - 700016

Disclaimer: The actual product may vary from the product shown as veneers are natural products and designs are unique and naturally evolved



Greenply  
MDF

# STEP INTO A NEW ERA OF PRECISION IN MDF

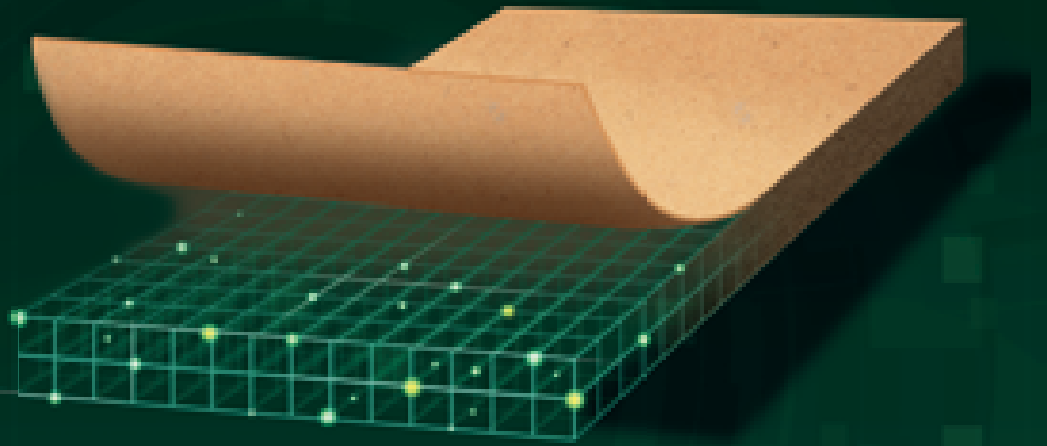

PROD-IQ   
NEO TECH 

Redefining quality, durability, and performance. Greenply MDF is rendered with cutting edge PROD-IQ NEO TECH which uses Artificial Intelligence to analyze microfibers to deliver each board with utmost precision.

Available Range: 710 HDMR HDF, Boil Pro 500, CARB P2 MDF, Prelam MDF, Exterior MDF, Interior MDF